

DESCRIPTION

The YC-841 is a back box specially designed for the N-8033MS flush-mount master station.

SPECIFICATIONS

Finish	Surface-treated steel plate, white
Dimensions	119 (W) × 258 (H) × 57 (D) mm (4.69" × 10.16" × 2.24")
Weight	1 kg (2.2 lb)
Accessory	Wall mounting screw ×4

APPEARANCE

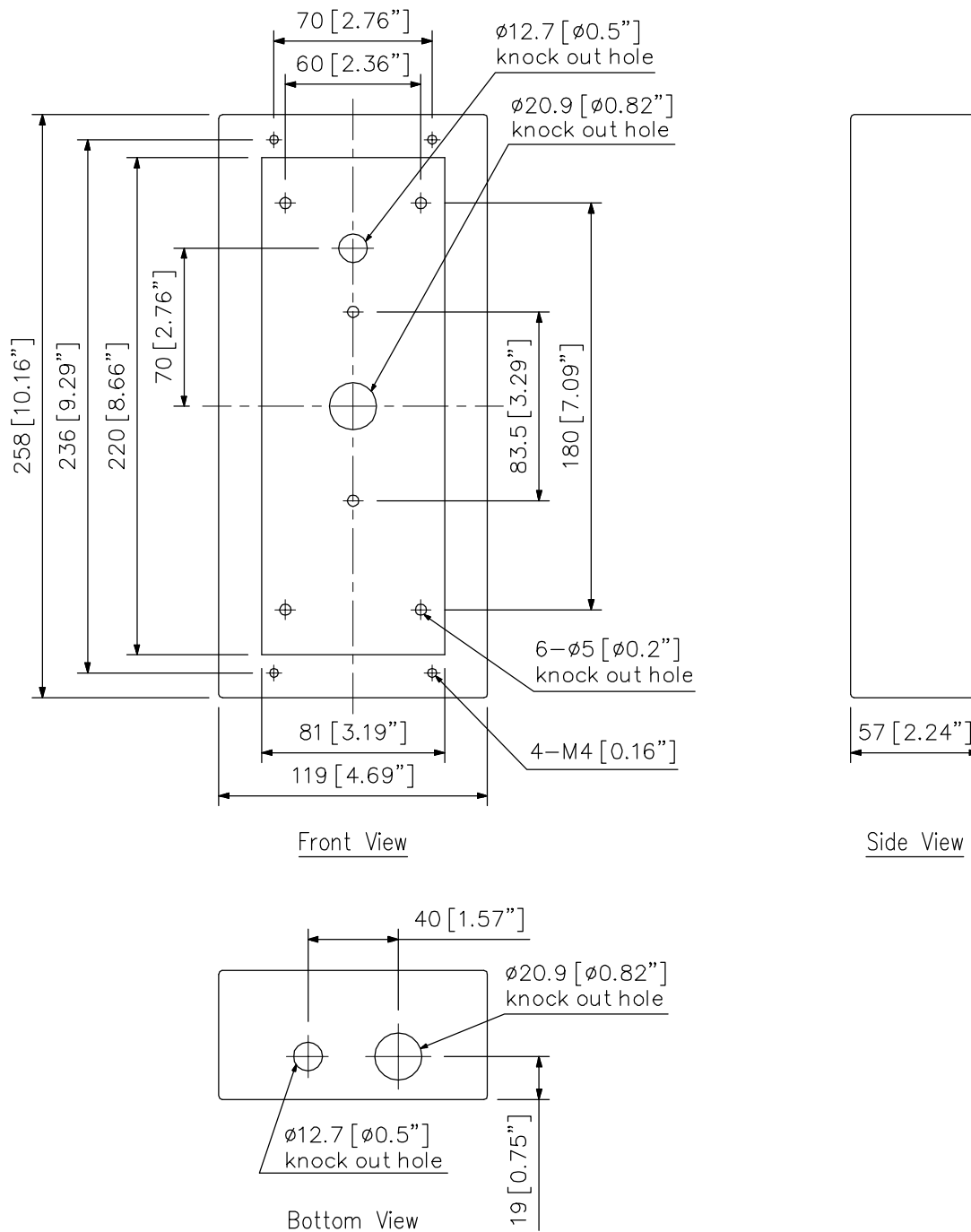

UNIT:mm SCALE:1/3